

Packed Bed System (PBS)

PureAIR

FILTRATION

Self-contained Air Purification System Removes Odors and Protects Your Equipment Investment

SPECIFICATIONS:

Applications	Protecting electronics, Wastewater odor control, & Environmental emission control
Airflow Range	200 CFM (339.8 CMH) – 5,600 CFM (9,514.4 CMH) <i>*Please review the model selection sheet for more information.</i>
Configuration	Horizontal airflow
Construction Material	Municipal Standard: Fiberglass reinforced plastic (FRP) Other options: Stainless Steel, Aluminum
Particulate Filtration	Odor Control Applications: Mist & Grease Filter Other Applications: 2", 30% MERV 8 Prefilter, 6", 95% MERV 13 Final Filter <i>*Other filter sizes/options available upon request. Please contact the factory for more information.</i>
Blower Configuration	DRAWTHRU: Standard and allows the blower to work in clean air, thus making it last longer and require lower maintenance BLOWTHRU: An option for customers who want less noise from the blower <i>*Redundant blowers & other special options available</i>
Customizable	Multiple sizes and configurations available, reference model selection chart for details. Add-on accessories like sound enclosures are available. Contact factory for more information. <i>*Don't see what you are looking for? PureAir specializes in customization. Contact us with your air filtration needs and we will work with you to find the best solution for your needs.</i>



BENEFITS:

- Low Maintenance: Bulk loading and unloading options
- Multiple beds available for adsorbent media. For more information on the adsorbent media, please see the media brochure.
- Horizontal footprint for spaces with limited height, but high airflow
- Side access door with quick release, snap, or positive pressure latches for quick and easy access to media and filters.
- All PBS units are UL listed and thus free from reasonable foreseeable fire risk.
- The system is the complete package designed for the removal of all organic and inorganic vapors or gases.
- Designed to ensure no bypass of contaminants and provides a minimum of 99.9% removal efficiency of constituent contaminants.

Media Bed Rod:

This unit is equipped with a metal Media Bed rod to detect the remaining life of the media. See back for more details.

Case Study
New Belgium



+1 678.935.1431 | Toll Free: 866.543.7479

www.PureAirFiltration.com | 6050 Peachtree Pkwy Suite 240-187. Atlanta, GA 30092

MODEL SELECTION TABLE

PBS MODEL PBS-	INDUSTRIAL APPLICATION MAX AIR FLOW CFM (CMH)	MUNICIPAL APPLICATION MAX AIR FLOW CFM (CMH)	MOTOR RANGE HP (kW)	MEDIA VOLUME FT ³ (M ³)*	SHIPPING WEIGHT EMPTY LBS (KG)	OPERATING WEIGHT LBS (KG)*
202	200 - 400 (340-680)	200 - 300 (340-510)	0.5 (0.4) - 1.5 (1.1)	16 (0.45)	670 (304)	1210 (549)
302	300- 600 (510-1020)	300 - 450 (510-760)	0.5 (0.4) - 1.5 (1.1)	22 (0.62)	710 (322)	1450 (658)
402	400-800 (680-1360)	400 - 600 (680-1020)	0.5 (0.4) - 2 (1.5)	28 (0.79)	740 (336)	1680 (762)
403	600- 1200 (1020-2040)	600 - 900 (1020-1530)	0.75 (0.6) - 2 (1.5)	42 (1.19)	820 (372)	2220 (1007)
404	800 - 1600 (1360-2720)	800 - 1200 (1360-	1 (0.7) - 3 (2.2)	56 (1.59)	1100 (499)	2970 (1347)
504	1000 - 2000 (1700-3400)	1000 - 1500 (1700-	2 (1.5) - 5 (3.7)	68 (1.93)	1500 (680)	3770 (1710)
604	1200 - 2400 (2040-4080)	1200 - 1800 (2040-	3 (2.2) - 5 (3.7)	80 (2.27)	2100 (953)	4770 (2164)
605	1500 - 3000 (2550-5100)	1500 - 2250 (2550-	3 (2.2) - 7.5 (5.5)	100 (2.83)	2700 (1225)	6040 (2740)
606	1800 - 3600 (3060-6120)	1800 - 2700 (3060-	5 (3.7) - 10 (7.4)	120 (3.40)	3000 (1361)	7000 (3175)
706	2100 - 4200 (3570-7140)	2100 - 3150 (3570-	7.5 (5.5) - 15 (11.0)	138 (3.91)	3500 (1588)	8100 (3674)
707	2450 - 4900 (4160-8320)	2450 - 3675 (4160-	7.5 (5.5) - 15 (11.0)	161 (4.56)	4100 (1860)	9470 (4296)
807	2800 - 5600 (4760-9500)	2800 - 4200 (4760-	10 (7.4) - 20 (14.7)	182 (5.15)	4800 (2177)	10870 (4931)

MEDIA BED ROD:



This unit is equipped with a metal Media Bed Rod. The rod is positioned inside the system at an angle against the direction of airflow and detects the expiration level of the media.

- Dark, corroded coloration on rod shows where media has expired. Once half the rod has been corroded, one should contact the factory to replace the media to ensure the proper functioning of the system.
- Interested in instant notification of media life? Ask about our Electronic Media Bed Rod that can be added to your system as an upgrade.

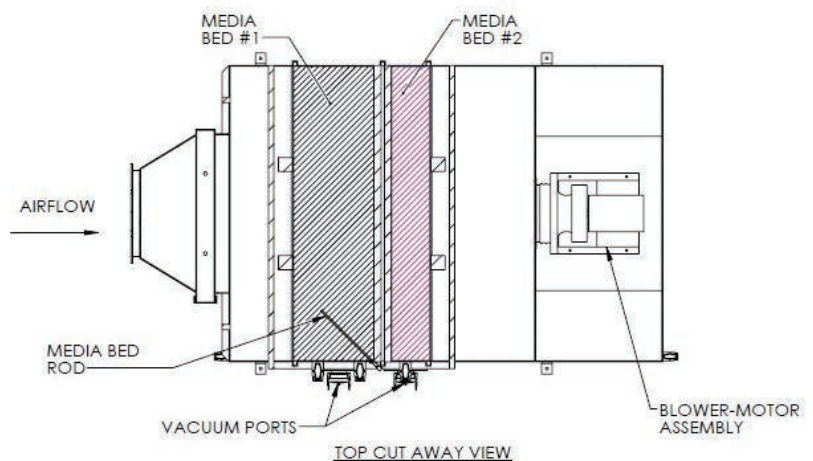
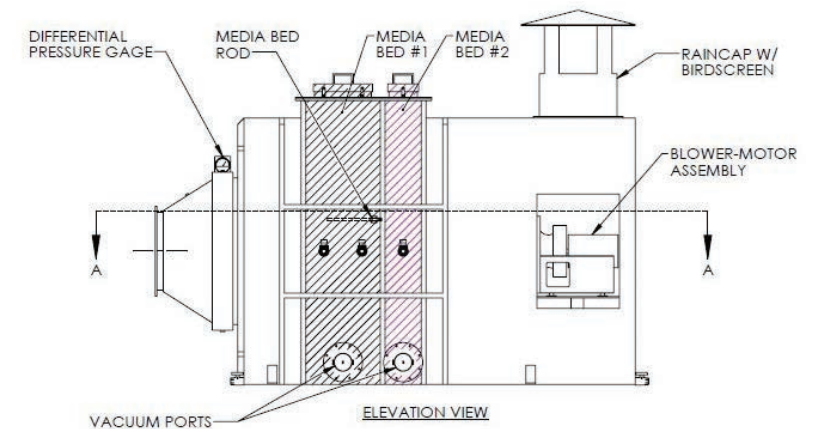

+1 678.935.1431

Toll Free: 866.543.7479

www.PureAirFiltration.com

6050 Peachtree Pkwy Suite 240-187. Atlanta, GA 30092

Revision 0